

CIN - U45203UP1972SGC003623

GSTIN 09AAACU3258KSZA
U.P. STATE BRIDGE CORPORATION LTD.
(A State Government Undertaking)
Office of the Dy. Project Manager
Bridge Construction Unit - Etawah
B-1 Kachahari Compound Near S.S.P. Chauraha



Off : (05688) 255951
Fax : (05688) 255951 2241

उ०प्र० राज्य सेतु निगम लि०
(उ०प्र० राज्य सरकार का उपक्रम)
कार्यालय: उप परियोजना प्रबन्धक
सेतु निर्माण इकाई-इटावा
बी-1 कचहरी कम्पाउण्ड
निकट एस.एस.पी. चौराहा
इटावा-206001

पत्रांक १५४ / Chambal / Bansari / Etw / 2019-20

दिनांक : 27/06/19

To,

All Empannelled Design Firms

Subject : - Modification in the design of 28.25 m Pre-stressed girder for Chambal River Bridge, Mahua-Suda-Bansari Marg in Distt. Etawah.

Quotation offers are invited from the consulting design firms for modification in the design of 28.25 m Beam Centre to Centre of bearing (3 Beam Arrangement) for the following lengths of beam as required in the above bridge due to the tilt and shift of wells :

1. 26.50 m c/c of bearing.
2. 29.00 m c/c of bearing.
3. 30.50 m c/c of bearing.

The dimensional X-section is attached herewith.

Encl. As Above.

(Nawab Singh)
Dy. Project Manager

Copy to following for information and necessary action Please.

1. G.M. (Kanpur), U.P. State Bridge Corporation Ltd. Kanpur.
2. Sri. Vishwajeet Srivastav, Dy. Project Manager, Computer Cell, U.P.S.B.C. Ltd. for uploading on UPSBC Ltd. Website.

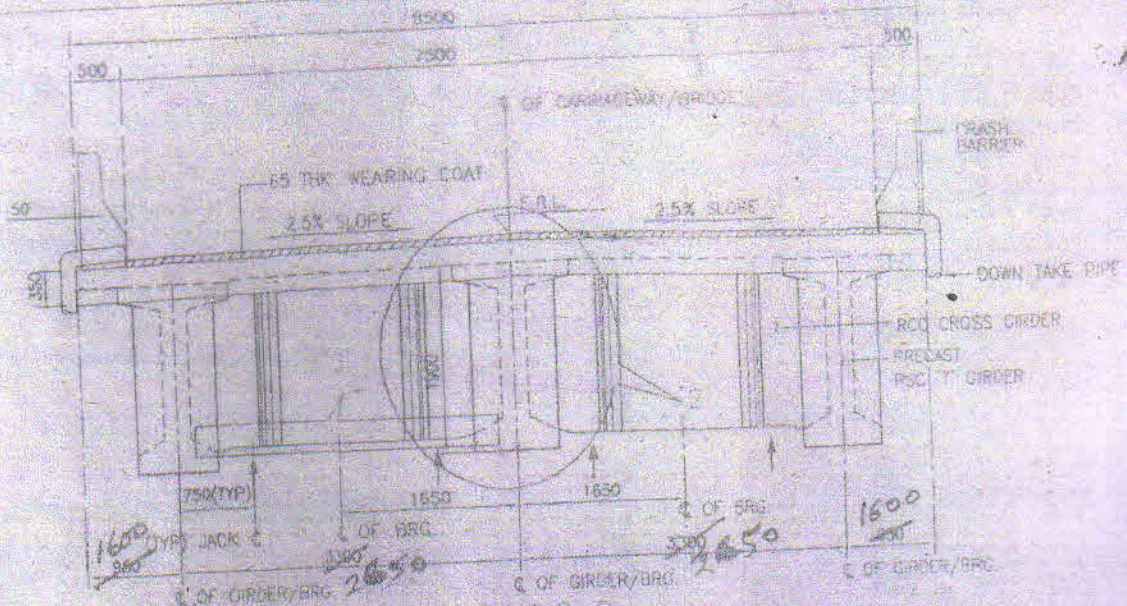

27.06.19
Dy. Project Manager

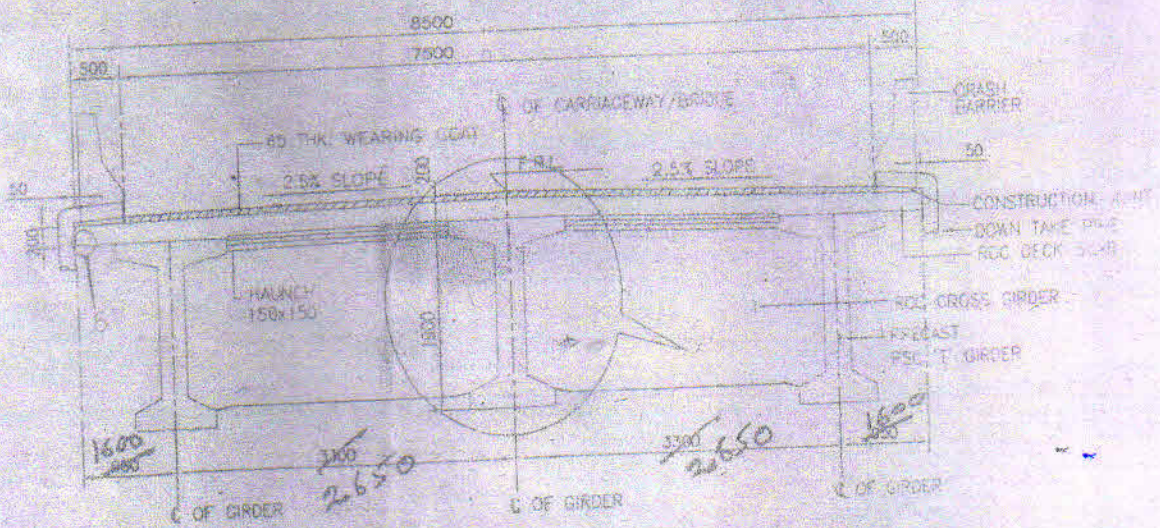

SECTION D-D
(SCALE=1/30)

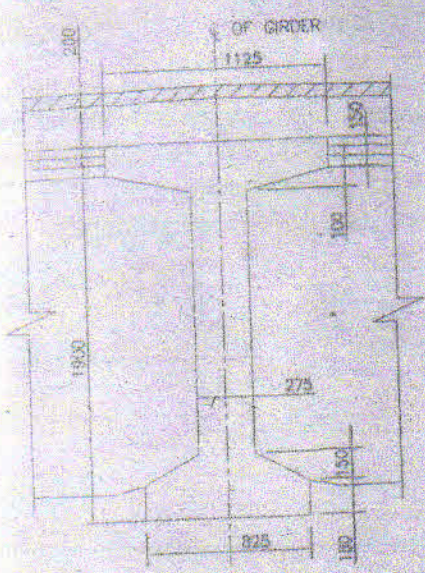

SECTION E-E
(SCALE=1/30)



DETAIL-1
(SCALE=1/25)

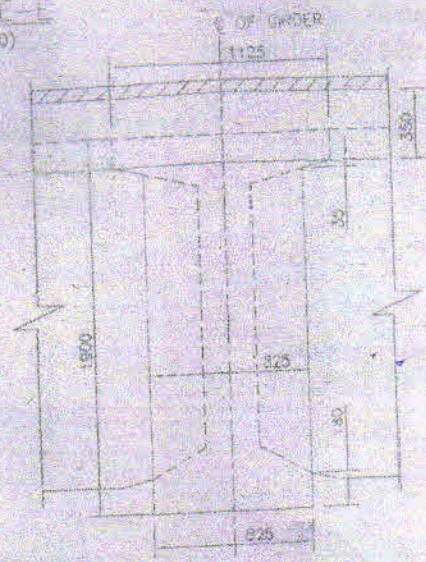

DETAIL-2
(SCALE=1/25)

CLIENT
M/S UP STATE BRIDGE CORPORATION LTD
LUCKNOW (U.P.)
16, MADAN MOHAN MALVIYA MARG
LUCKNOW-226001

PROJECT
DESIGN OF PRE-STRESSED SUPERSTRUCTURE
(3 BEAMS AT C/B BEARINGS)
(3 BEAMS ARRANGEMENT)